

EVA

Alto
one



Read this manual carefully before use and keep it for future reference. Failure to do so may result in injury, property damage and may void the warranty.

evalife.co.uk

•• Contents

- 02 •• Contents
- 02 •• Languages
- 03 •• Important instructions
- 04 •• Quick start guide
- 04 ••• Setup
- 04 ••• Air quality display
- 05 ••• Touch panel controls
- 06 ••• Parts guide
- 07 ••• Filter
- 07 •• Specifications
- 08 •• CE Certificate

•• Important instructions

WARNING: THIS APPLIANCE CONTAINS MAGNETS

01. Pacemakers and defibrillators may be affected by strong magnetic fields. If you or someone in your household has a pacemaker or defibrillator, avoid close contact with the device.
02. Credit cards and electronic storage media may be affected by magnets and should be kept away from the top of the appliance.

TO REDUCE THE RISK OF FIRE, ELECTRIC SHOCK, OR INJURY:

03. Disconnect power or unplug before cleaning, performing any maintenance or replacing a filter.
04. This appliance is not intended for use by persons with reduced physical, sensory or mental capabilities, or lack of experience and knowledge, unless they have been given supervision or instruction concerning use of the appliance by a person responsible for their safety.
05. Children should be supervised to ensure that they do not play with the appliance.
06. Do not use this appliance in the immediate surroundings of a bath, shower, swimming pool or any other source of water.
07. To avoid overheating, do not cover the appliance.
08. If the supply cable is damaged, it must be replaced or repaired by the manufacturer or similarly qualified persons in order to avoid a hazard.
09. Do not use this appliance in small rooms when they are occupied by persons not capable of leaving the room on their own, unless constant supervision is provided.
10. Do not use outdoors or on wet surfaces and do not handle any part of the appliance or plug with wet hands.
11. Keep the appliance away from any flammable liquid or gasses.
12. Do not use this appliance if it has been damaged or submerged in water.
13. Do not use this appliance if it has been dropped or if it has visible signs of damage.
14. Keep this appliance and cable away from heated surfaces. Do not position the cable under furniture or appliances.
15. Do not put any objects into the air purifier opening as this may cause an electric shock.
16. Always use this appliance on a horizontal and stable surface.
17. If there is a loose fit between the plug and the socket or the plug becomes very hot, the socket may need to be replaced. Check with a qualified electrician to replace the socket.

•• Quick start guide

••• Setup



Remove the Base plate

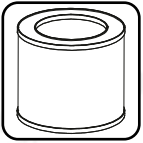

Before use, be sure to remove all packaging from the unit and filters.

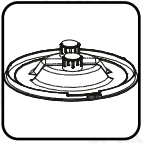

An optional feature is the aromatherapy sponges, which sit in the base plate. Add a small amount of fragrance oil to the sponge to scent your room as it is purified. Essential oils are not recommended and can damage the plastics.

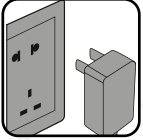

Plug the air purifier into a mains outlet. The lights will flash on indicating the unit is in standby mode.

••• Air quality display

A set of LED's illuminate the clean air outlet. The air quality sensor indicates 'Particulate Matter' in the air down to 2.5 microns. The colour indicate the air quality.



Blue
0-50
Perfect

Green
51-100
Normal

Purple
101-150
Poor

Red
151+
High Risk

••• Touch panel controls

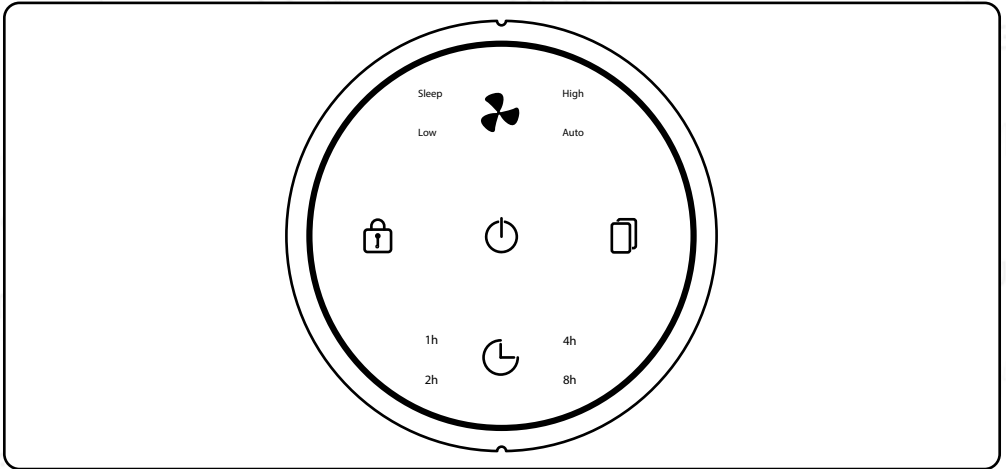

Press to toggle the air purifier between 'on' and 'standby'.



Fan speed affects how fast air is drawn through the purifier. Select sleep to dim lights and lower fan speed.



Child lock. Press for three seconds to toggle On/Off.



Reset. Press for three seconds to reset filter replacement timer.



Choose between a 1 hour / 2 hour / 4 hour / 8 hour timer.

••• Parts guide

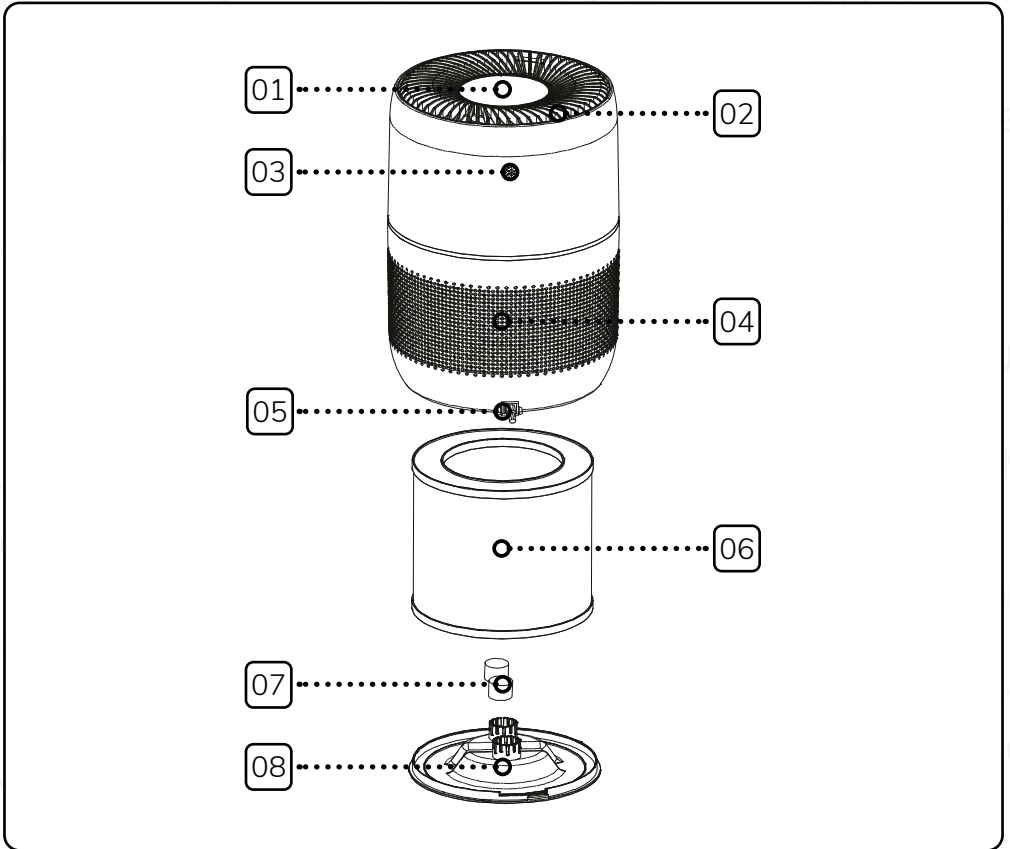

01. Touch panel controls

02. Clean air outlet / Air quality colour display

03. Air quality sensor

04. Air inlet

05. Power supply

06. True HEPA antibacterial & active carbon filter

07. Aromatherapy sponges

08. Base plate

••• **Filter**

The air from your room passes through the filter capturing pollutants in the process. When the filter need to be replaced, a ‘buzz’ sound will play. Once this stops, the replacement light will start flashing. Insert new filter and hold reset button (see ‘Touch panel controls’ section).

True HEPA Antibacterial & active carbon filter

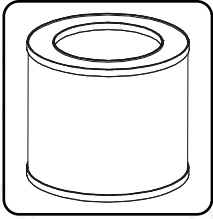

The ‘High-Efficiency Particulate Air’ filter captures particles as small as 0.3 microns.

Ultra porous activated carbon granules absorb harmful chemicals, gases and odours.



Replacement filters are available at evalife.co.uk

•• **Specifications**

Model	Alto one
Power (W)	28
CADR	140
Application area (m ²)	36
Noise level (dB)	16
Dimensions (mm)	225x225x310
Weight (kg)	2.5



EVA will capture airborne particles, however we recommend vacuuming pre-existing dust and allergens from furnishings.

•• CE Certificate

EU Declaration of Conformity

We hereby declare that the machine described below complies with the relevant basic safety and health requirements of the EU Directives, both in its basic design and construction as well as in the version put into circulation by us. This declaration shall cease to be valid if the machine is modified without our prior approval.

As authorised by: Blue Marble

Declares that:

Description: EVA Air Purifier

Identification code: Alto one, Alto four, Alto nine, Alto infinity

Conforms to the following directives and standards:

- 2014/35/EU - Low Voltage Directive
- 2014/30/EU - Electromagnetic Compatibility (EMC) Directive
- 2011/65/EU, 2015/863 - RoHS Directive

Harmonized standards applied:

EN 55014-1:2017, EN 61000-3-2:2014, EN 61000-3-3:2013, EN 55014-2:2015, EN 301 489-1 V2.1.1, EN 301 489-17 V3.1.1, EN 300 328 V2.1.1, EN 62311:2008, EN 300 328 V2.1.1.

Notified body: Blue Marble

The technical documentation is kept by: Blue Marble

Date: 01/10/2020

Signed:



Blue Marble

Name and address of the manufacturer: ATL Moorland Gate, Chorley
PR6 9FE